

Cortica 002 Planter

Design Roda studio

Technical Information



Reminiscent of a tree trunk. CORTICA is a brown cork planter with a cylindrical shape and rounded edges, ready to house and enhance plants and flowers. The material is completely natural and consists of particles of cork bound by resins from the original plant and treated with high-temperature water vapour. CORTICA can be used as a pot or a planter: the drainage hole in the base can be left open or blocked with the special plug supplied, also made of cork.

TECHNICAL INFORMATION

DESCRIPTION
Planter for outdoor use.

STRUCTURE
cork.

WEIGHT
Structure 9 kg

DIMENSION
Ø 50 × H 50 cm
Ø 19" 5/8 × H 19" 5/8

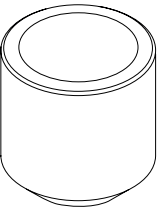

Materials

STRUCTURE

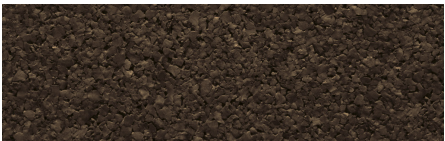

Cork